

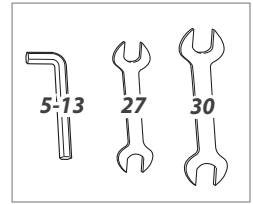

IS

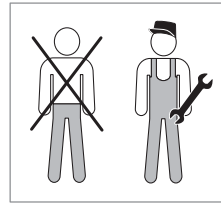

🛒 Serie Planet - Detentori - Lockshields

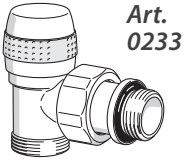

Art. 0233

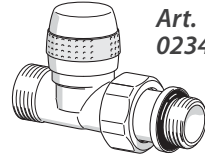

Art. 0234

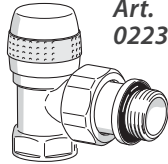

Art. 0223

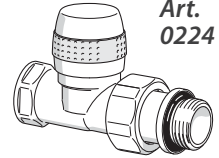

Art. 0224



Art. 0481



- ∅ 10
- ∅ 12
- ∅ 14
- ∅ 15
- ∅ 16
- ∅ 18

Art. 0483



- ∅ 7.5/8-12
- ∅ 9.5/10-14
- ∅ 9.5/10-15
- ∅ 10.5/11-15
- ∅ 10.5/11-16
- ∅ 11.5/12-16
- ∅ 12.5/13-17
- ∅ 12.5/13-18
- ∅ 13.5/14-18
- ∅ 14.5/15-20
- ∅ 15/15.5-20
- ∅ 15.5/16-20

Art. 0490

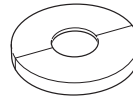

- 3/8"
- 1/2"

- ∅ 10
- ∅ 12
- ∅ 14
- ∅ 15
- ∅ 16
- ∅ 18

Art. 0491

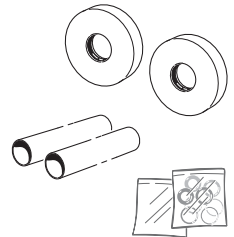

Art. 0481

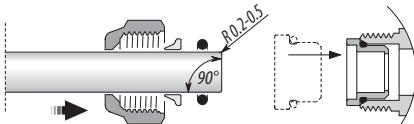

1

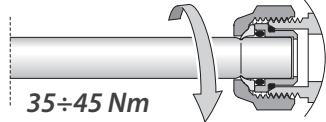

2

Art. 0483

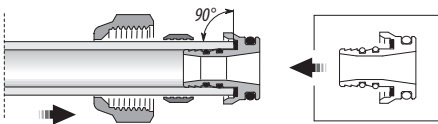

1

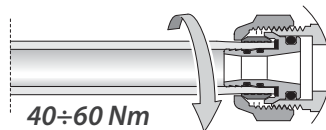

2



2 - 130°C (36-266°F)

Max 10 bar (145 psi)



Canapa - PTFE (Teflon)
Hemp - PTFE (Teflon)

1

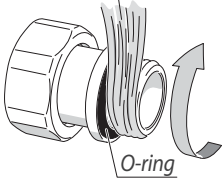

O-ring

2

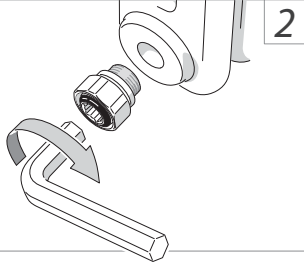

3

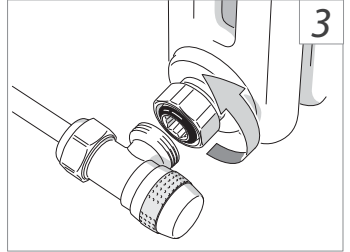

4

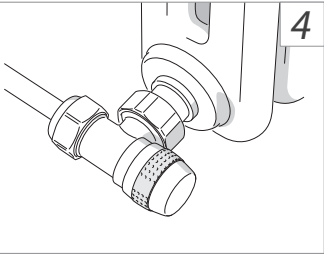

5

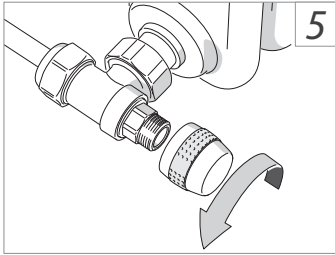

6

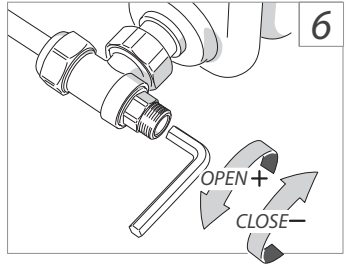

OPEN+
CLOSE-



3/8" Art. 0223-0233

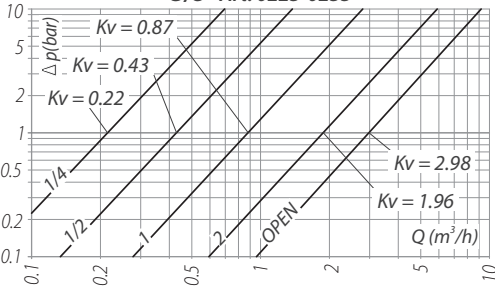

1/2" Art. 0223-0233

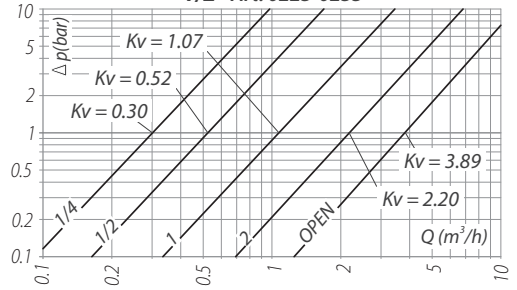

3/8" Art. 0224-0234

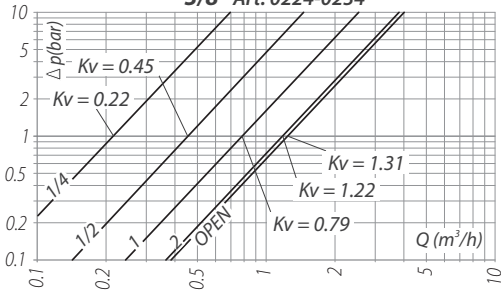

1/2" Art. 0224-0234

